

WEST SIDE ELEVATION  
(REAR ELEVATION)

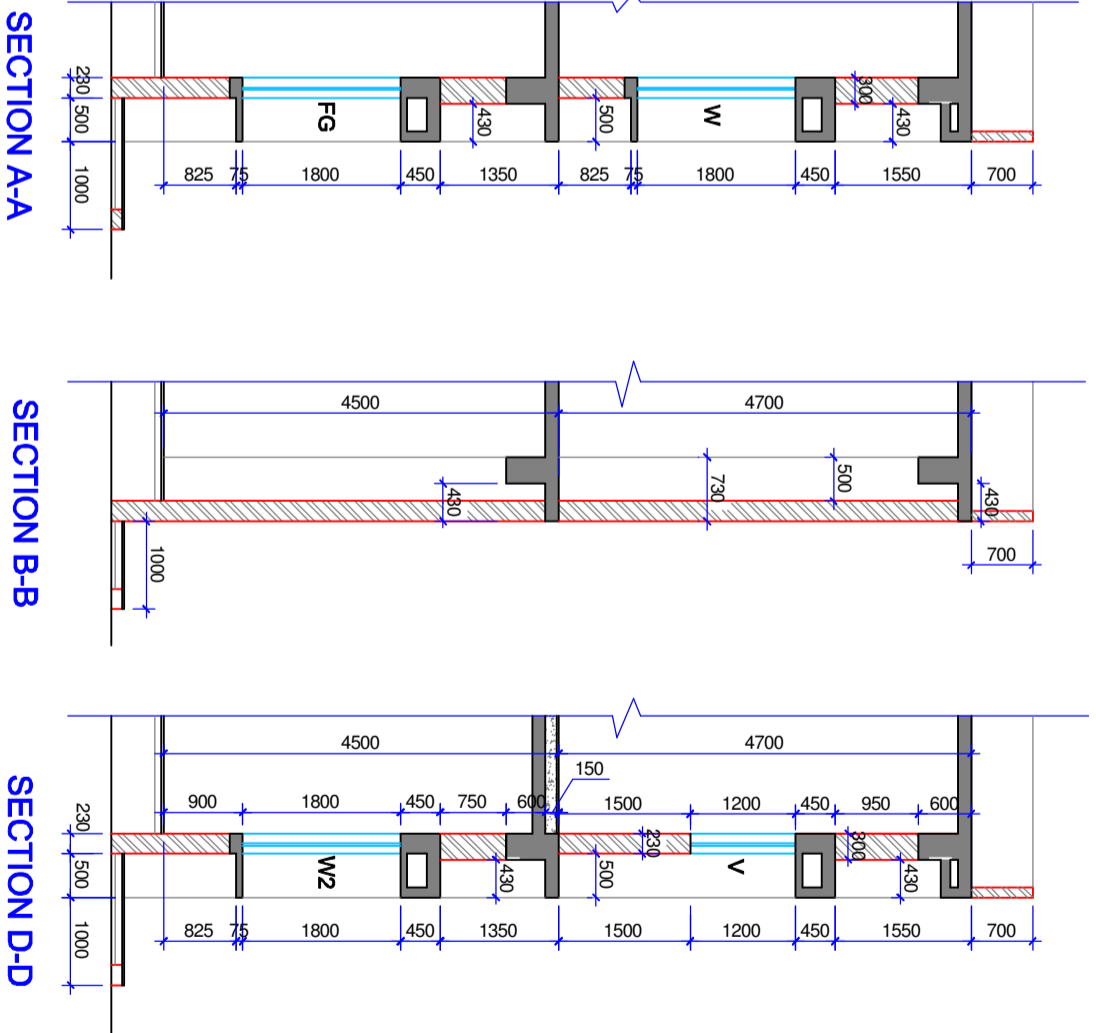

SECTION A-A

SECTION B-B

SECTION D-D

— EXISTING WALL LINE  
— PROPOSED WALL LINE

FOR TENDER ONLY

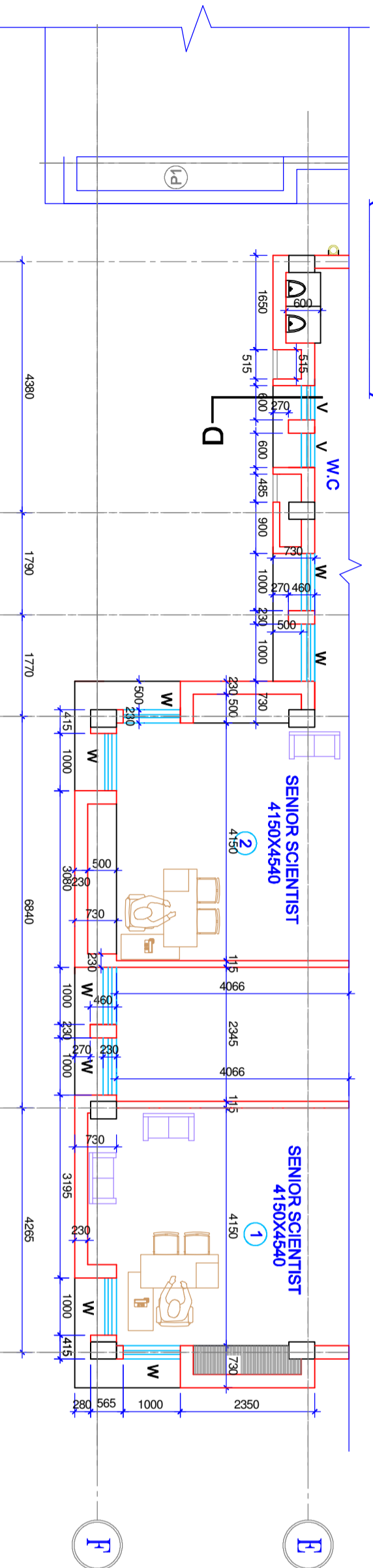

FIRST FLOOR PLAN

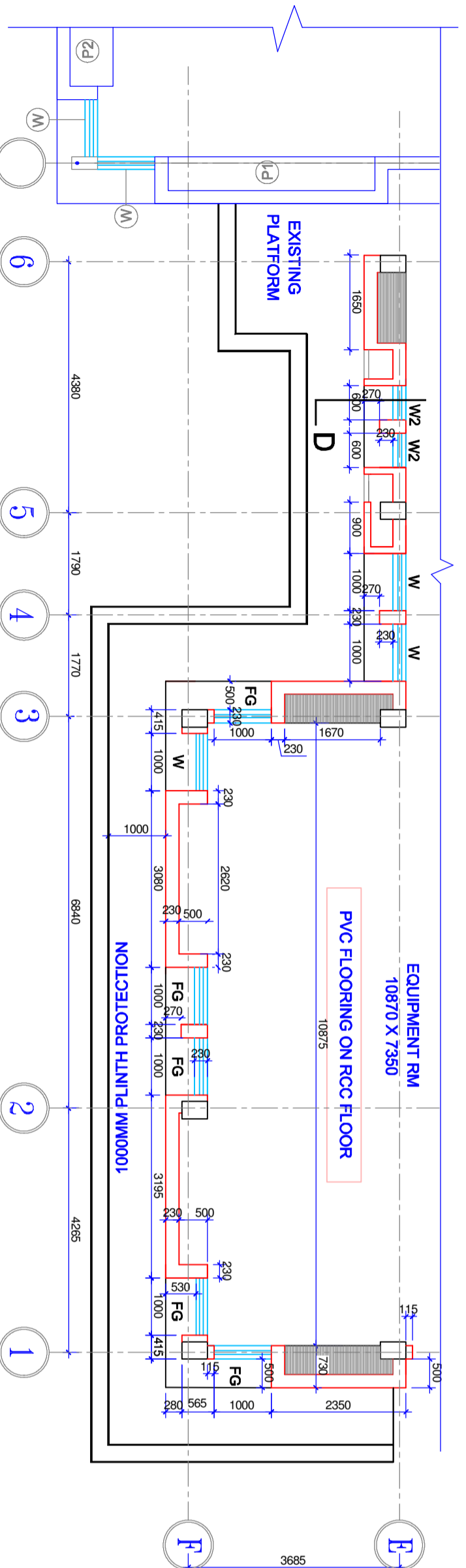

GROUND FLOOR PLAN

PROJECT :		EXTENSION OF MET. LAB BUILDING AT A.R.C.I. BALAPUR.	
TITLE :		WEST SIDE ELEVATION	
CLIENT :		A.R.C.I. BALAPUR	
CONSULTANTS :		S.S.INFRASTRUCTURE PROJECT CONSULTANTS PVT.Ltd. # 25 & 9, JABBAR BUILDINGS, BEGUMPET, HYDERABAD-16 Ph: +91 40 66310954, 66310240 FAX No.: +91 40 66312949. email: sspcppl@gmail.com	
DATE :	02.06.14	SHEET NO.:	
DEALT BY :	M.GANESH	05	
ARCHITECT :	A.V.LAKSHMI		
PRINCIPAL CONSULTANT:	S.S.RAO		
DRG.NO : SSIPCPL / ARCI / METLAB / WEST ELE / AD -05			

COPY RIGHT OF THIS DRAWING BELONGS TO  
M/S S.S. INFRASTRUCTURE PROJECT CONSULTANTS PVT.LTD.  
AND SHOULD NOT BE USED FOR ANY PURPOSE OTHER THAN SPECIFIED  
WITHOUT PRIOR PERMISSION.